



Product Features

- Simple set up through Bluetooth App
- 12 VDC operation
- 5 cycles, all fully adjustable
- Treated Water Refill with pre-brine option
- Programming ease and options increase efficiency, save salt and water
- Strong, durable Noryl® valve body, weather insect resistant one-piece slide cover
- Proprietary two valve bypass with 1" MNPT Connections
- 9V battery back-up
- Will motor to a drain line shut off position if power fails during regeneration
- Switch Output for:
 - Full Cycle Function
 - Backwash Function
- Limited 7 year warranty

Optional Configurations

- Backwash filter
- Meter initiated regeneration
- Nitro & Sidekick Single Tank Aeration Systems

**BYPASS CONNECTOR
OPTIONS**

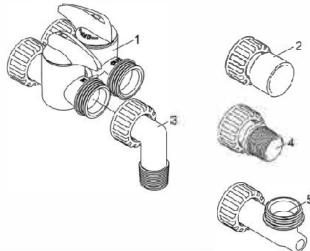

| Valve Specifications | |
|--|--|
| Valve Material | Noryl®* |
| Inlet / Outlet | 1" |
| Cycles | 5 |
| Flow Rates (50 psi inlet) - Valve Alone | |
| Continuous (15 psi drop) | 21 gpm |
| Peak (25 psi drop) | 27 gpm |
| CV (flow at 1 psi drop) | 5.4 |
| Max. backwash (25 psi drop) | 17 GPM |
| Regeneration | |
| Downflow / Upflow | Downflow |
| Adjustable Cycles | Yes |
| Time Available | 99 minutes per cycle |
| Meter Information | |
| Meter Accuracy Range | .25 - 15 gpm +/- 5% |
| Meter Capacity Range (gal.) | 1 - 9,999 |
| Dimensions | |
| Distributor Pilot | 1.050" O.D. |
| Drain Line | 1/2" NPT Q.C. |
| Brine Line | 3/8" |
| Mounting Base | 2-1/2" - 8 NPSM |
| Height From Top of Tank | 7.7" |
| Typical Applications | |
| Water Softener | 6" - 16" Diameter up to 4 ft ³ Capacity |
| Iron Filter | 6" - 16" Diameter |
| Sediment Filter | 6" - 16" Diameter |
| Carbon Filter | 6" - 16" Diameter |
| Neutralizing Filter | 6" - 16" Diameter |
| Additional Information | |
| Electrical Rating | 12 VDC |
| Pressure | Hydrostatic: 300 psi Working: 20 - 125 psi |
| Temperature | 34 ° - 110 ° F |

*Noryl is a registered trademark of General Electric Company